

Planning for Livability and Community Connection  
US 181: CORPUS CHRISTI HARBOR BRIDGE

Anthony Jones  
Texas Division



# PROJECT OVERVIEW

- The construction of the new US 181 Harbor Bridge is currently in the final phase which includes the design and construction of the bridge.
- The project includes replacement of the existing Harbor Bridge and reconstruction of portions of US 181, I-37 and the Crosstown Expressway. The project will include the development, design, construction, and maintenance of a total of 6.44 miles of bridge and connecting roadway.
- The bridge will include six-lane sections of US 181, three lanes in each direction with a median barrier, shoulders, and a bicycle and pedestrian shared-use path.
- Additionally, the project includes the reconstruction of approximately 1.6 miles of I-37, reconstruction of approximately one mile of the Crosstown Expressway and demolition of the existing Harbor Bridge.
- Improve safety and long term maintenance of bridge with the chosen FEIS recommended the “Red” alternative as preferred route.





# US 181 Harbor Bridge FEIS





# ISSUES

- Title VI Complaint - alleged TxDOT was discriminating against the Hillcrest Neighborhood by not taking into consideration the increased air pollution, noise impacts, increased isolation and decreased property values the bridge project would bring to a predominately African American community.
- FHWA accepted the complaint based upon the allegation that the proposed construction of the project (along the Recommended alignment) would result in a disparate impact on the Hillcrest neighborhood by further isolating the neighborhood from the rest of the city.



# MITIGATION EFFORTS

- Citizens Advisory Committee (CAC) comprised of representatives from the Washington Coles and Hillcrest Communities -2014
- The Livability Plan would identify the needs of the community and would seek to promote an overall revitalization of the area.
- Voluntary Resolution Agreement (VRA) committed TxDOT to mitigation measures to offset the severe and highly adverse effects on specifically the Hillcrest and to somewhat a lesser degree the Washington Coles Neighborhoods that were fully disclosed in the January 8, 2016 FHWA Record of Decision and based on the FEIS.
- Voluntary Acquisition Program (VAP) a three-year period from May 2016 to the end date of May 2019. All relocations and subsequent purchases of residential property would become solely owned by the Port of Corpus Christi and no longer be considered residential.





# COMMUNITY CONTEXT



- Historic African American and Hispanic community that was endured 50 plus years of redlining, disinvestment, and segregation.
- Population in 2010 was 3,105 residents. In 2017 population decreased to 2,972 residents.
- Expected population after VRP is to approximately max 130



# Current Status

## Acquisition

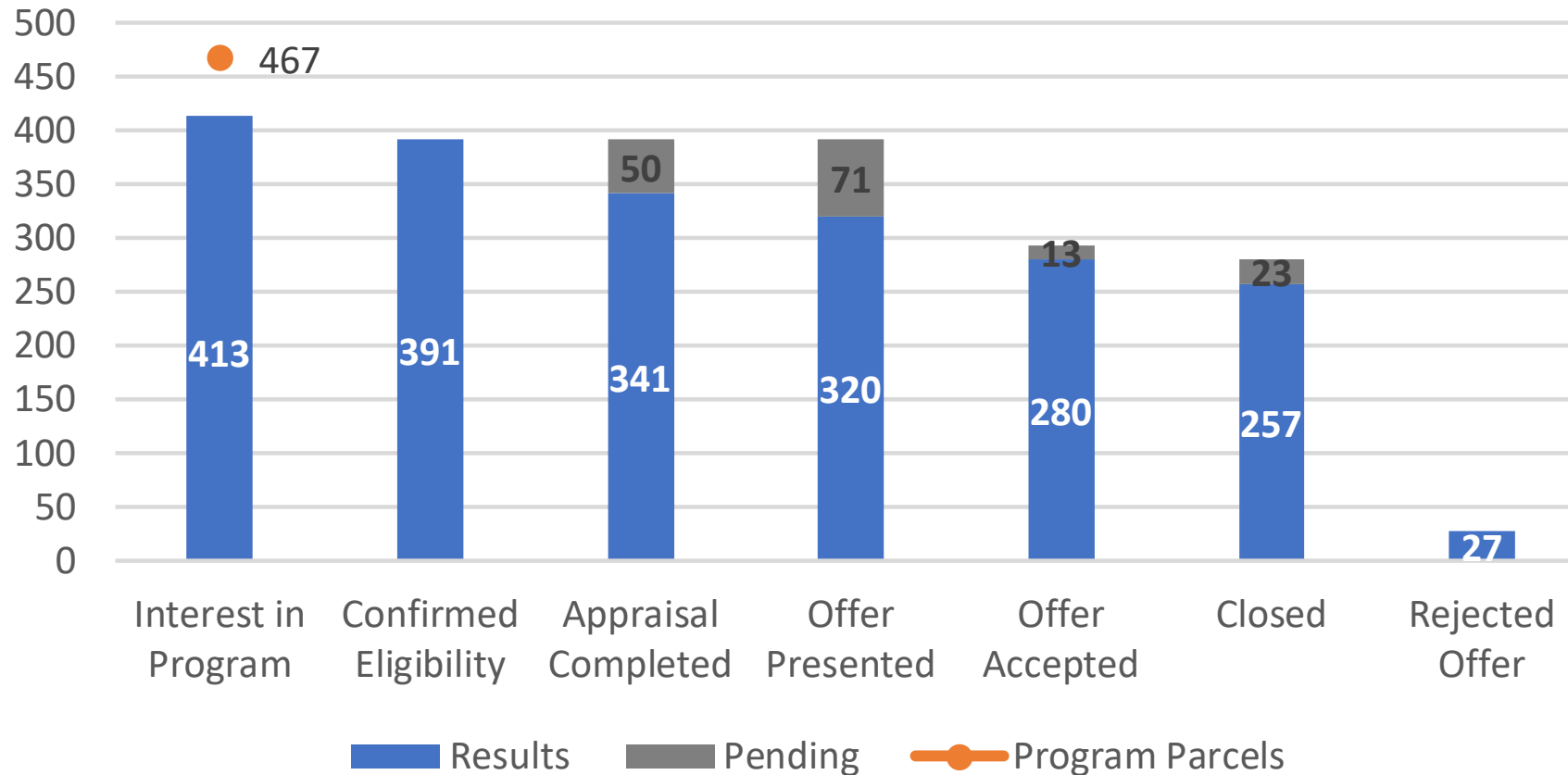

103 parcel did not participate in the program, they either declined the offer (27), did not opt into the program (54) or did not provide the required eligibility documents needed to move forward in the program (22).

\* As of 09/09/2019





# Legend

91 Closed

165 Demolished

Map Information  
This map is for informational purposes  
only and has not been prepared for,  
or is suitable for legal,  
engineering,  
or planning purposes.



# LIVABILITY PRINCIPLES

- **PROVIDE MORE TRANSPORTATION CHOICES:** Develop safe, reliable, and economical transportation choices to decrease household transportation costs, reduce our nation's dependence on foreign oil, improve air quality, reduce greenhouse gas emissions, and promote public health.
- **PROMOTE EQUITABLE, AFFORDABLE HOUSING:** Expand location- and energy-efficient housing choices for people of all ages, incomes, races, and ethnicities to increase mobility and lower the combined cost of housing and transportation.
- **ENHANCE ECONOMIC COMPETITIVENESS:** Improve economic competitiveness through reliable and timely access to employment centers, educational opportunities, services, and other basic needs by workers, as well as expanded business access to markets.
- **SUPPORT EXISTING COMMUNITIES:** Target federal funding toward existing communities—through strategies like transit-oriented, mixed-use development, and land recycling—to increase community revitalization and the efficiency of public works investments and safeguard rural landscapes.
- **COORDINATE AND LEVERAGE FEDERAL POLICIES AND INVESTMENT:** Align federal policies and funding to remove barriers to collaboration, leverage funding, and increase the accountability and effectiveness of all levels of government to plan for future growth, including making smart energy choices such as locally generated renewable energy.
- **VALUE COMMUNITIES AND NEIGHBORHOODS:** Enhance the unique characteristics of all communities by investing in healthy, safe, and walkable neighborhoods— rural, urban, or suburban.







## COMMUNITY CONNECTIONS

- **Invest** to leverage new opportunities and create positive outcomes, such as a multimodal investment or streetscape improvement defined as part of a community revitalization plan.
- **Renew** to rehabilitate or reconstruct older projects at the end of their life cycle, such as a freeway conversion that replaces obsolete infrastructure with a new context-sensitive facility.
- **Restore** by addressing unanticipated consequences of past transportation investments, such as a new highway cap or multimodal bridge in an urban center that connects the surrounding neighborhoods and activates the city space.
- **Repair** by reducing or mitigating the potential downsides of a particular facility, such as roadway modernization project or an environmental stewardship activity.





# MOBILITY AND ACCESS

- The removal of Harbor Bridge and re-alignment of highway US 181 provides a significant opportunity to radically remake the transportation infrastructure by bringing back the local street grid that defined the area in the pre-highway era.
- The improved local connectivity of the local street grid within the neighborhoods, while connecting them back downtown.
- Implementation of Bike and Pedestrian Paths along the new Harbor Bridge alignment and neighborhood

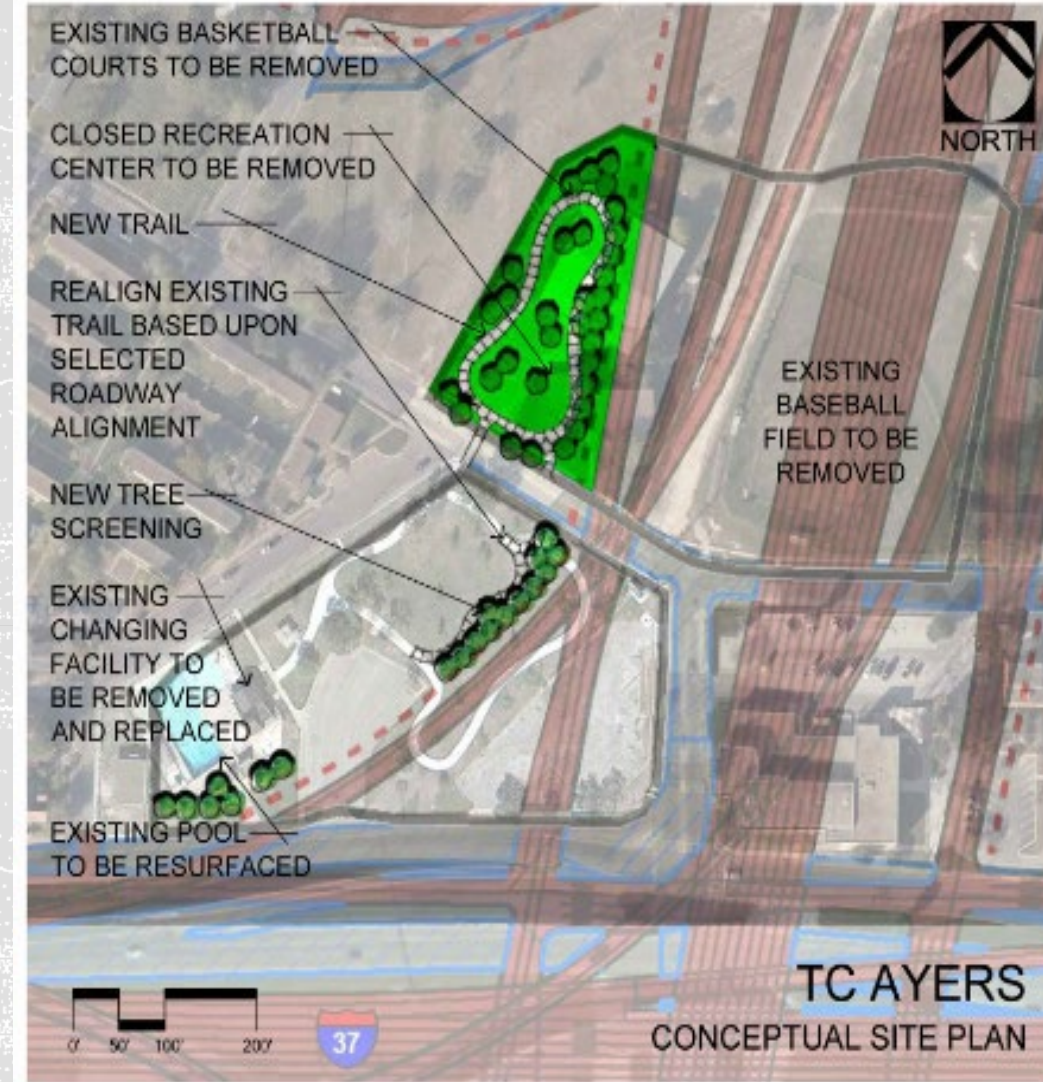





- Currently there has been 7 Livability Committee Meeting
- 1 Stakeholder Livability Draft Plan Review and Comment Session
- 2 Community Livability Draft plan page turn and review
- 1 more review and comment session to occur in November
- Plan delivery January 2020

# PROGRESS





# RESOURCES & LINKS

- FHWA Community Connection Website

[https://www.fhwa.dot.gov/planning/community\\_connections/](https://www.fhwa.dot.gov/planning/community_connections/)

- FHWA Livability Website:

<https://www.fhwa.dot.gov/livability/>

- Harbor Bridge Project Website:

<https://harborbridgeproject.com>

